

Falls

Indian Creek Bull Trout Survey

7/14/89

Upper S. Spring

South Spring

North Spring

Road

Falls

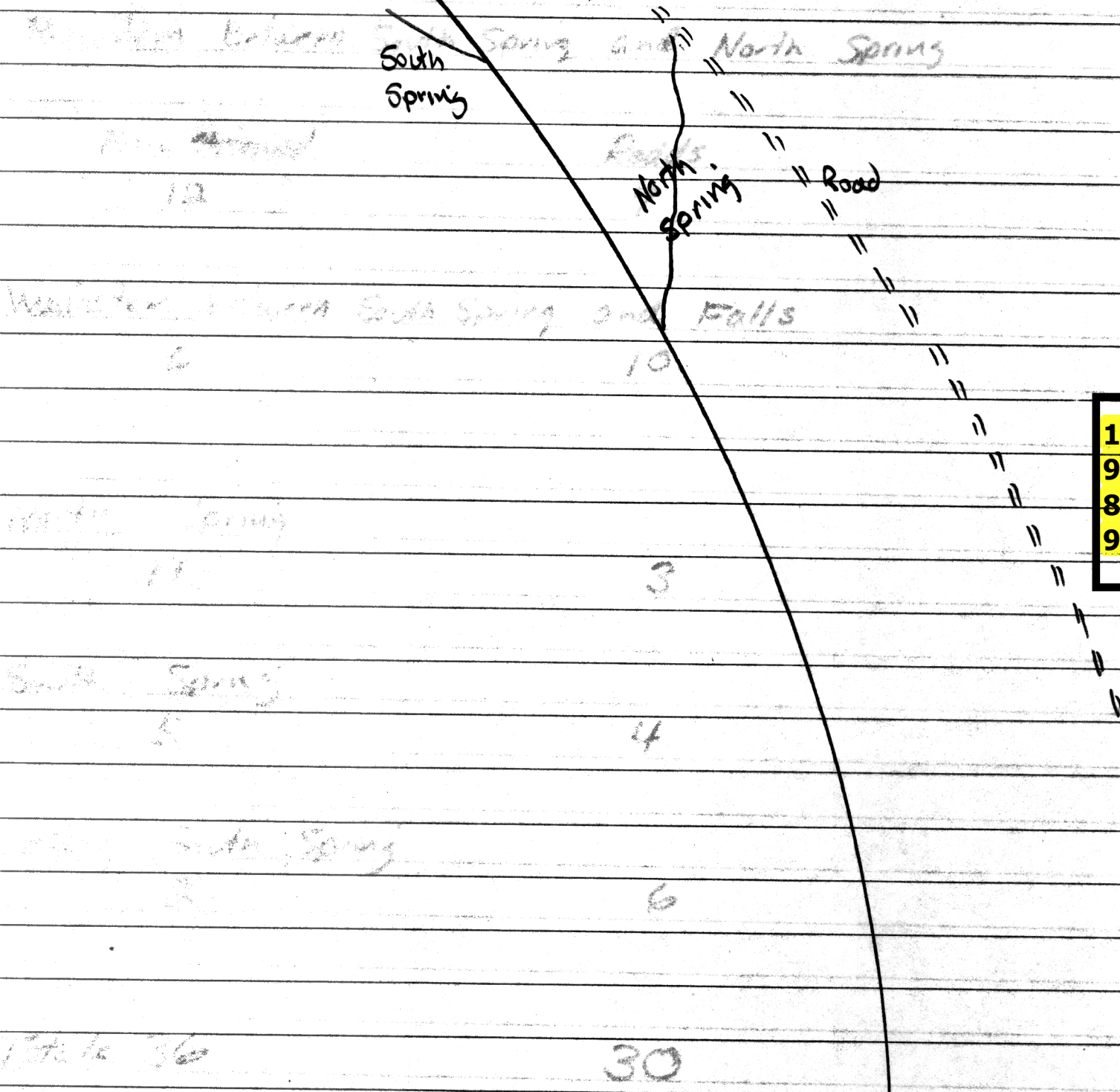

1989

All points were marked with surveyor's ribbon (blue)

White Pass Highway

Rimrock Lake - Indian Creek Bull Trout Survey
Cummins - Anderson 9/14/89

Mainstem between South Spring and North Spring

Fish Observed

12

Redds

7

Mainstem between South Spring and Falls

6

10

North Spring

11

3

South Spring

5

4

Upper South Spring

2

6

Totals 36

30

All redds were marked with surveyors ribbon (blue)

White Pass Highway

11
9
8
9

Rimrock Lk - Indian Creek Bull Trout Survey
 Anderson 9/28/89 Water Temp. 47°F

Mainstem between S. Spring + N. Spring

	<u>Fish Observed</u>		<u>Old Redds</u>		<u>New Redds</u>		<u>Total Redds</u>
9-14-89		9-28-89	9-14-89		9-28-89		
12		ϕ	7		3		10

Mainstem between S. Spring and Falls

6	1	10	2	12
---	---	----	---	----

N. Spring

11	ϕ	3	2	5
----	---	---	---	---

S. Spring

5	4	4	ϕ	4
---	---	---	---	---

Upper S. Spring

2	ϕ	6	ϕ	6
---	---	---	---	---

Mainstem from N. Spring to Bridge

ϕ	2	2
---	---	---

Old Redds were marked with Blue Surveyors Ribbon.

Total fish

observed = 37

Total Redds = 39

1
9
8
9

559 09/15/89 1200 LGB

AS4AS5 BOX CANYON CR



"TROUT", PROBABLY CUTTS.

NO FISH ALL THE WAY TO PEEK-A-BOO FALLS POOL. STREAM FLOWING INTO THE LAKE THIS YEAR AND ACCESS IS POSSIBLE. SAW ALL BULL TROUT IN PEEK-A-BOO POOL. TWO WERE LYING IN TAILOUT AND SPOOKED AS WE TOPPED THE BOULDERS. QUIET OBSERVATION SHOWED AT LEAST 5 INDIVIDUAL FISH AS THEY CRUISED THE POOL AND/OR JUMPED AND "PEEKED" AT THE FALLS. BEST JUMP WAS A LARGE FISH (24-26") WHICH MADE IT ABOUT 2/3 OF THE WAY TO FIRST STEP. SAW 8-10 LEAPS AND 10-12 PEEKS. USFS CREW FROM CLE ELUM (SCOTT EDSON) SURVEYED THE HABITAT ABOUT TWO DAYS EARLIER AND FOUND AN IMPASSABLE FALLS OF 20-FEET OR SO JUST 1/8 MILE ABOVE MAIN CULVERT/BRIDGE (THEY ONLY SAW 2 ADULT BULL TROUT IN THIER SURVEY WORK, ALL BELOW PEEK-A-BOO).

561 09/20/89 1300 LGB

AS4AS5 BOX CANYON CR

NO REDDS, NO BULL TROUT OBSERVED. APPEAR TO HAVE LOST THE 5 FISH SEEN LAST TIME IN PEEK-A-BOO POOL. DID SEE THREE UNUSUALLY LARGE CUTTHROATS OF 11-12" IN SOME OF THE CLEAR DEEP POOLS THROUGH THE CANYON. ABOUT 1/3 TO 1/2 OF DISCHARGE ACTUALLY REACHING THE LAKE AND FISH SHOULD HAVE NO PROBLEM ENTERING THE STREAM. IF THIS RUN IS TYPICALLY EARLY-RUNNING (JULY-AUGUST) WE MAY BE LOSING THEM TO POACHING/VANDALISM RATHER THAN HAVING A MIGRATION PROBLEM.

Stream Lake Fish Database
Box Canyon 1989

Year	Wa_nam	Date	Temp	New Redds	False_redds	Total_visible
1989	BOX CANYON CR	9/15/1989	10	0	0	0
1989	BOX CANYON CR	9/20/1989	8	0	0	0
1989	BOX CANYON CR	9/25/1989	8	0		
1989	BOX CANYON CR	10/9/1989		0		

1
9
8
9

09/29/89 1155 EA	Z16Z17 DEEP CR		BELOW ROAD 1800: 5 REDDS, 0 ADULTS LIVE, ENTRAILS OF ONE BULL TROUT OBSERVED. ABOVE ROAD 1800 (ABOUT 1 MILE): 12 REDDS, NO LIVE BULL TROUT AND ONE CARCASS OF A LARGE BULL TROUT.
09/24/90 1155 EA	Z16Z17 DEEP CR		FROM BRIDGE ON USFS RD 1800 TO ABOUT 3 MILES UPSTREAM (2.7 MILES UP FROM Y INTERSECTION OF ROADS 1800 AND 1808). SLOUGH AREA BY RD 1808 WHERE I CAME OUT. WENT TO APPARENT BLOCKAGE CAUSED BY LOW FLOW AND SUBTERRANEAN FLOW. MAY HAVE BEEN FISH ABOVE THIS POINT BY EARLIER MIGRATION TIMING; WILL CHECK IT OUT NEXT YEAR. NO BULL TROUT SEEN. SUSPECT SPAWNING IN EARLY TO MID-SEPTEMBER. WILL START 1991 SURVEYS EARLIER.
09/10/91 1155 EA	Z16Z17 DEEP CR	★	FROM RD 1800 UPSTREAM 3 MILES JUST PAST SMALL POND BY ROAD 1808: 76 REDDS, 3 FALSE, 2 ADULTS (APPROX. 16"). TEMP 44F. LOW FLOW BLOCKAGE AS FLOW GOES SUBTERRANEAN. ELECTROFISHING SHOWED ONE ADULT BULL TROUT (445mm F) TRAPPED IN POOL, 8 JUVENILE BULL TROUT FROM 72-131mm, 1 BROOK TROUT 92mm, AND LOTS OF SCULPINS. FROM ROAD 1800 DOWNSTREAM TO LAKE: 8 REDDS, 6 ADULTS (MOSTLY KELTED), AND ONE CARCASS OF 690mm BULL TROUT (otoliths taken).
			STAFF GAUGE ABOVE DOUBLE CULVERT ON RD 1800 READ 1.98 (feet?).
09/01/92 1000 EA	Z16Z17 DEEP CR	★	SPAWNING APPEARED 80-90 PERCENT COMPLETE, NEED TO START SURVEYS IN MID-AUGUST IN THIS STREAM. STAFF GAUGE 1.90 (WAS 1.98 LAST YR) LOW FLOW CONDITIONS CAUSED STREAM TO DRY UP ABOUT 1.7 MILES FROM MOUTH. FOUND 2 ADULT BLC HEADS FROM POACHING AND 2 ADULT BLC MORTS. ALSO OBS. 2 LIVE AND 1 DEAD BLC JUV 6-8" AND ABOUT 25 LIVE BLC FRY OF 1-2". 6 OF THE 25 ADULT BLCs WERE IN LG POOL BELOW RD 1800 AND NOT ON REDDS. REDD CLASSIFICATION: DEFINITE 69, PROBABLE 8, POSSIBLE 8
09/10/92 0900 EA	Z16Z17 DEEP CR		REDD CLASSIFICATION: DEFINITE 77, PROBABLE 1, POSSIBLE 7.
08/13/93 0845 EA	Z16Z17 DEEP CR		Initial or preliminary trip. No spawning activity and no adult bull trout observed. Several small fry were observed. Unlike last year, the channel above 1.7 miles from mouth has considerable flow. Last year the channel was dried up above that point. Staff gauge at FSRD1800 bridge at 2.00
08/24/93 0900 EA	Z16Z17 DEEP CR		Eric calls this one his "first pass" Water 44F at FSRD1800 bridge, BOR staff gauge at 2.00

Alcady entered

09/29/89 1155 EA

216217 DEEP CR

BELOW ROAD 1800: 5 REDDS, 0 ADULTS LIVE, ENTRAILS OF ONE BULL TROUT OBSERVED. ABOVE ROAD 1800 (ABOUT 1 MILE): 12 REDDS, NO LIVE BULL TROUT AND ONE CARCASS OF A LARGE BULL TROUT.

09/24/90 1155 EA

216217 DEEP CR

Alcudia entered

FROM BRIDGE ON USFS RD 1800 TO ABOUT 3 MILES UPSTREAM (2.7 MILES UP FROM Y INTERSECTION OF ROADS 1800 AND 1808). SLOUGH AREA BY RD 1808 WHERE I CAME OUT. WENT TO APPARENT BLOCKAGE CAUSED BY LOW FLOW AND SUBTERRANEAN FLOW. MAY HAVE BEEN FISH ABOVE THIS POINT BY EARLIER MIGRATION TIMING; WILL CHECK IT OUT NEXT YEAR. NO BULL TROUT SEEN. SUSPECT SPAWNING IN EARLY TO MID-SEPTEMBER. WILL START 1991 SURVEYS EARLIER.

09/10/91 1155 EA

216217 DEEP CR

FROM RD 1800 UPSTREAM 3 MILES JUST PAST SMALL POND BY ROAD 1808: 76 REDDS, 3 FALSE, 2 ADULTS (APPROX. 16"). TEMP 44F. LOW FLOW BLOCKAGE AS FLOW GOES SUBTERRANEAN. ELECTROFISHING SHOWED ONE ADULT BULL TROUT (445mm F) TRAPPED IN POOL, 8 JUVENILE BULL TROUT FROM 72-131mm, 1 BROOK TROUT 92mm, AND LOTS OF SCULPINS. FROM ROAD 1800 DOWNSTREAM TO LAKE: 8 REDDS, 6 ADULTS (MOSTLY KELTED), AND ONE CARCASS OF 690mm BULL TROUT (otoliths taken).

STAFF GAUGE ABOVE DOUBLE CULVERT ON RD 1800 READ 1.98 (feet?).

09/01/92 1000 EA

216217 DEEP CR

SPAWNING APPEARED 80-90 PERCENT COMPLETE, NEED TO START SURVEYS IN MID-AUGUST IN THIS STREAM. STAFF GAUGE 1.90 (WAS 1.98 LAST YR)
LOW FLOW CONDITIONS CAUSED STREAM TO DRY UP ABOUT 1.7 MILES FROM MOUTH. FOUND 2 ADULT BLC HEADS FROM POACHING AND 2 ADULT BLC MORTS. ALSO OBS. 2 LIVE AND 1 DEAD BLC JUV 6-8" AND ABOUT 25 LIVE BLC FRY OF 1-2". 6 OF THE 25 ADULT BLCs WERE IN LG POOL BELOW RD 1800 AND NOT ON REDDS.

REDD CLASSIFICATION: DEFINITE 69, PROBABLE 8, POSSIBLE 8

09/10/92 0900 EA

216217 DEEP CR

REDD CLASSIFICATION: DEFINITE 77, PROBABLE 1, POSSIBLE 7.

08/13/93 0845 EA

216217 DEEP CR

Initial or preliminary trip.
No spawning activity and no adult bull trout observed.
Several small fry were observed. Unlike last year, the channel above 1.7 miles from mouth has considerable flow. Last year the channel was dried up above that point.

Staff gauge at FSRD1800 bridge at 2.00

08/24/93 0900 EA

216217 DEEP CR

Eric calls this one his "first pass"

Water 44F at FSRD1800 bridge, BOR staff gauge at 2.00

from jct of Forest Service Roads 1800 and 1808.
Spawning appears to have just started.

From FSRD 1800									
Upstream abt 1.5 mi.					Downstream to mouth				Total
Def	Prob	Poss	BLC		Def	Prob	Poss	BLC	DEF →
6	5	0	5		3	1	2	4	9
<u>TOTALS</u>									
DEF					9				
PROB					6				
POSS					2				
BLC					9				



TOTALS
DEF 9
PROB 6
POSS 2
BLC 9

1109 09/02/93 0900 EA 216217 DEEP CR

Eric's "second pass" survey.

BOR staff gauge at 1.90

A 100-ft section of the main channel was dry about 0.7 miles up from jct of roads 1800/1808, adequate flow above though. One 19-inch dead bull trout found in dewatered channel, covered with aggressive bees. Bumping Lake drawdown just recently started and may be affecting channel dessication. Upper portions of braided channels become a series of impassable beaver dams. 12 fry obs.

One head/entrails found at bridge campground, took otoliths, maxillary length 60mm, branchiostegals R12, L13.

From USFS RD1800 Bridge									
Upstream to 0.7 mi.					Downstream to Lake				
	Def	Prob	Poss	BLC	Def	Prob	Poss	BLC	
Old	6	3	0	7	3	1	1	6	
New	13	1	6		9	1	2		
Total	19	4	6	7	12	2	3	6	

Overall Counts
Definite redds 31
Probable redds 6
Possible redds 9
adult BLC 13

1110 09/10/93 0830 EA 216217 DEEP CR

Eric's "third pass" and final survey.

BOR staff gauge at Rd 1800 bridge at 1.90 still.

Stream dried up along most of rock slide (much more than on last survey, 8 days ago). One stranded bull trout (24") in dry channel.

Two old definite redds were high and dry with several more in danger of drying up.

From FSRD1800 up 0.7 mi.					From FSRD1800 down to Lake				
	DEF	PROB	POSS	BLC	DEF	PROB	POSS	BLC	
OLD	19	3	6	0	12	1	3	0	
NEW	7	0	0		3	0	0		

002681

2681

09/29/89 1155 EA	Z16Z17 DEEP CR		BELOW ROAD 1800: 5 REDDS, 0 ADULTS LIVE, ENTRAILS OF ONE BULL TROUT OBSERVED. ABOVE ROAD 1800 (ABOUT 1 MILE): 12 REDDS, NO LIVE BULL TROUT AND ONE CARCASS OF A LARGE BULL TROUT.
09/24/90 1155 EA	Z16Z17 DEEP CR		FROM BRIDGE ON USFS RD 1800 TO ABOUT 3 MILES UPSTREAM (2.7 MILES UP FROM Y INTERSECTION OF ROADS 1800 AND 1808). SLOUGH AREA BY RD 1808 WHERE I CAME OUT. WENT TO APPARENT BLOCKAGE CAUSED BY LOW FLOW AND SUBTERRANEAN FLOW. MAY HAVE BEEN FISH ABOVE THIS POINT BY EARLIER MIGRATION TIMING; WILL CHECK IT OUT NEXT YEAR. NO BULL TROUT SEEN. SUSPECT SPAWNING IN EARLY TO MID-SEPTEMBER. WILL START 1991 SURVEYS EARLIER.
09/10/91 1155 EA	Z16Z17 DEEP CR	★	FROM RD 1800 UPSTREAM 3 MILES JUST PAST SMALL POND BY ROAD 1808: 76 REDDS, 3 FALSE, 2 ADULTS (APPROX. 16"). TEMP 44F. LOW FLOW BLOCKAGE AS FLOW GOES SUBTERRANEAN. ELECTROFISHING SHOWED ONE ADULT BULL TROUT (445mm F) TRAPPED IN POOL, 8 JUVENILE BULL TROUT FROM 72-131mm, 1 BROOK TROUT 92mm, AND LOTS OF SCULPINS. FROM ROAD 1800 DOWNSTREAM TO LAKE: 8 REDDS, 6 ADULTS (MOSTLY KELTED), AND ONE CARCASS OF 690mm BULL TROUT (otoliths taken).
			STAFF GAUGE ABOVE DOUBLE CULVERT ON RD 1800 READ 1.98 (feet?).
09/01/92 1000 EA	Z16Z17 DEEP CR	★	SPAWNING APPEARED 80-90 PERCENT COMPLETE, NEED TO START SURVEYS IN MID-AUGUST IN THIS STREAM. STAFF GAUGE 1.90 (WAS 1.98 LAST YR) LOW FLOW CONDITIONS CAUSED STREAM TO DRY UP ABOUT 1.7 MILES FROM MOUTH. FOUND 2 ADULT BLC HEADS FROM POACHING AND 2 ADULT BLC MORTS. ALSO OBS. 2 LIVE AND 1 DEAD BLC JUV 6-8" AND ABOUT 25 LIVE BLC FRY OF 1-2". 6 OF THE 25 ADULT BLCs WERE IN LG POOL BELOW RD 1800 AND NOT ON REDDS. REDD CLASSIFICATION: DEFINITE 69, PROBABLE 8, POSSIBLE 8
09/10/92 0900 EA	Z16Z17 DEEP CR		REDD CLASSIFICATION: DEFINITE 77, PROBABLE 1, POSSIBLE 7.
08/13/93 0845 EA	Z16Z17 DEEP CR		Initial or preliminary trip. No spawning activity and no adult bull trout observed. Several small fry were observed. Unlike last year, the channel above 1.7 miles from mouth has considerable flow. Last year the channel was dried up above that point. Staff gauge at FSRD1800 bridge at 2.00
08/24/93 0900 EA	Z16Z17 DEEP CR		Eric calls this one his "first pass" Water 44F at FSRD1800 bridge, BOR staff gauge at 2.00

Alcady entered

from jct of Forest Service Roads 1800 and 1808.
Spawning appears to have just started.

From FSRD 1800									
Upstream abt 1.5 mi.					Downstream to mouth				Total
Def	Prob	Poss	BLC		Def	Prob	Poss	BLC	DEF →
6	5	0	5		3	1	2	4	9
<u>TOTALS</u>									
DEF 9									
PROB 6									
POSS 2									
BLC 9									



TOTALS
DEF 9
PROB 6
POSS 2
BLC 9

1109 09/02/93 0900 EA 216217 DEEP CR

Eric's "second pass" survey.

BOR staff gauge at 1.90

A 100-ft section of the main channel was dry about 0.7 miles up from jct of roads 1800/1808, adequate flow above though. One 19-inch dead bull trout found in dewatered channel, covered with aggressive bees. Bumping Lake drawdown just recently started and may be affecting channel dessication. Upper portions of braided channels become a series of impassable beaver dams. 12 fry obs.

One head/entrails found at bridge campground, took otoliths, maxillary length 60mm, branchiostegals R12, L13.

From USFS RD1800 Bridge									
Upstream to 0.7 mi.					Downstream to Lake				
	Def	Prob	Poss	BLC	Def	Prob	Poss	BLC	
Old	6	3	0	7	3	1	1	6	
New	13	1	6		9	1	2		
Total	19	4	6	7	12	2	3	6	

Overall Counts
Definite redds 31
Probable redds 6
Possible redds 9
adult BLC 13

1110 09/10/93 0830 EA 216217 DEEP CR

Eric's "third pass" and final survey.

BOR staff gauge at Rd 1800 bridge at 1.90 still.

Stream dried up along most of rock slide (much more than on last survey, 8 days ago). One stranded bull trout (24") in dry channel.

Two old definite redds were high and dry with several more in danger of drying up.

From FSRD1800 up 0.7 mi.					From FSRD1800 down to Lake				
	DEF	PROB	POSS	BLC	DEF	PROB	POSS	BLC	
OLD	19	3	6	0	12	1	3	0	
NEW	7	0	0		3	0	0		

002681

2681

										Live Dead	Redds False					
07/07/92	1200	LGB	39		AT3AT4 R	GOLD CR				DV BULL	0	0				
09/25/84	1200	JS	39	20	AT3AT4 R	GOLD CR (LOWER)	9.50			DV BULL	0	2	2	0	2	1
10/05/84	1200	JS	39	20	AT3AT4 R	GOLD CR (LOWER)				DV BULL	0	0	0	0	2	1
09/09/85	0833	JS	39	20	AT3AT4 R	GOLD CR (LOWER)				DV BULL	0	0	0	0	0	0
09/13/85	0951	JS	39	20	AT3AT4 R	GOLD CR (LOWER)				DV BULL	0	0	0	0	0	0
09/14/85		JS	39		AT3AT4 R	GOLD CR (LOWER)				DV BULL	0	0	1	2	0	0
09/20/85	0831	JS	39	20	AT3AT4 R	GOLD CR (LOWER)				DV BULL	0	0	0	0	0	0
09/30/85		JS	39		AT3AT4 R	GOLD CR (LOWER)				DV BULL	0	0	0	0	2	0
09/22/86	1500	LGB	39	20	AT3AT4 R	GOLD CR (LOWER)				DV BULL	3	9	12	1	0	0
08/27/87	1300	LGB	39	20	AT3AT4 R	GOLD CR (LOWER)				DV BULL	0	0	1	0	SPEARED	21
09/17/87	1000	LGB	39	20	AT3AT4 R	GOLD CR (LOWER)	53F			DV BULL	0	4	4	0	0	0
10/05/87	1030	LGB	39	20	AT3AT4 R	GOLD CR (LOWER)	52F			DV BULL	0	7	7	0	15	43
09/15/88	1200	LGB	39	20	AT3AT4 R	GOLD CR (LOWER)	56F			DV BULL	0	4	4	0	4	3
09/22/88	1100	LGB	39	20	AT3AT4 R	GOLD CR (LOWER)	52F			DV BULL	0	4	4	0	12	70
09/15/89	0900	LGB	39	20	AT3AT4 R	GOLD CR (LOWER)	52F			DV BULL	0	4	4	0	1	0
09/20/89	1000	LGB	39	20	AT3AT4 R	GOLD CR (LOWER)	52F			DV BULL	0	4	4	0	2	17
09/27/90	1330	LGB	39	20	AT3AT4 R	GOLD CR (LOWER)	58F			DV BULL	0	0	0	0	2	0
09/13/91	1400	LGB	39	20	AT3AT4 R	GOLD CR (LOWER)				DV BULL	0	0	0	0	0	0
09/20/91	NBRD	FG	39	20	AT3AT4 R	GOLD CR (LOWER)				DV BULL	0	0	0	MEMO ---	NO COUNT	
09/18/92	from	FRI	39		AT3AT4 R	GOLD CR (LOWER)				DV BULL	0	0	16	0	6	0
09/30/92	1017	BDB	39		AT3AT4 R	GOLD CR (LOWER)	51F			DV BULL	0	0	0	0	3	
10/20/92	1000	BDB	39		AT3AT4 R	GOLD CR (LOWER)	48F			DV BULL	0	0	0	0	0	5
09/23/93	1201	FRI	39		AT3AT4 R	GOLD CR (LOWER)	11.20			DV BULL	0	0	0	SURVEY	CANCELLED	RAIN
09/18/90	1000	LGB	39	20	AT3AT4 R	GOLD CR (UPPER)	52F			DV BULL	0	2	2	0	2	0
09/19/91	CERD	KS	39	20	AT3AT4 R	GOLD CR (UPPER)				DV BULL	0	0	2	2	9	0
09/20/91	NBRD	FG	39	20	AT3AT4 R	GOLD CR (UPPER)				DV BULL	0	0	2	2	3	0
09/18/92	from	FRI	39		AT3AT4 R	GOLD CR (UPPER)				DV BULL	0	0	20		10	
10/09/92	1015	BDB	39		AT3AT4 R	GOLD CR (UPPER)	8.00			DV BULL	0	0	0	0	11	3
09/23/93	1200	FRI	39		AT3AT4 R	GOLD CR (UPPER)	9.60			DV BULL	0	0	2	2	2	0
09/18/90		WDW	38	30	Y74Y75 R	HINDOO CR	48F			DV BULL	0	0	0	0	2	LOST 15 OF 17
09/08/84	1200	JS	38	23	Y58Y59 R	INDIAN CR				DV BULL	6	140	146	1	3	0
09/15/84	1200	JS	38	23	Y58Y59 R	INDIAN CR	110			DV BULL	20	25	45	0	3	6
09/12/85		JS	38		Y58Y59 R	INDIAN CR				DV BULL	0	0	90	FALSE IN	CLUDED	69
09/17/85	0943	JS	38	23	Y58Y59 R	INDIAN CR				DV BULL	0	0	62	0	37	18
09/03/86		JS	38		Y58Y59 R	INDIAN CR				DV BULL	0	0	45	PARTIAL	SURVEY	16
09/12/87		JS	38		Y58Y59 R	INDIAN CR				DV BULL	0	0	20			35
09/02/88	1101	EA	38	23	Y58Y59 R	INDIAN CR	43F			DV BULL	0	0	25	0	8	0
09/09/88	1103	EA	38	23	Y58Y59 R	INDIAN CR	45F			DV BULL	0	0	25	0	22	0
09/16/88	1105	EA	38	23	Y58Y59 R	INDIAN CR	48F			DV BULL	0	0	23	1	unknown	25
09/26/88	1107	EA	38	23	Y58Y59 R	INDIAN CR	43F			DV BULL	0	0	0	0	25	0
09/14/89	1201	EA	38	23	Y58Y59 R	INDIAN CR				DV BULL	0	0	0	0	25	0

09/22/88 1100 LGB	AT3AT4 GOLD CR (LOWER)	<p>KOKANEE YET.</p> <p>MOST OF THE "FALSE" REDDS WERE PROBABLY KOKANEE SPAWNING. SEVERAL HUNDRED KOKS IN THE STREAM, LARGER THAN NOTED IN THE PAST, AT 10-12 INCHES. FIVE OF THE BULL TROUT WERE MALES AND ONLY ONE WAS A FEMALE. IMPOSSIBLE TO CONTINUE BULL TROUT REDD COUNTS NOW WITH KOKANEE ACTIVE. BEDROCK POOL BELOW THE GRAVEL PIT HELD ITS USUAL SEVERAL BULL TROUT AND TWO WERE OBSERVED CRUISING THE LAKE SHORELINE ON THE WAY BACK. MANY, MANY HUMAN FOOTPRINTS AND 4X4 WHEEL TRACKS ALL OVER THE CREEK CHANNEL AND GRAVEL BARS.</p>
09/15/89 0900 LGB	AT3AT4 GOLD CR (LOWER)	<p>ONE REDD BETWEEN I-90 AND FRONTAGE RD. ONE MALE AND ONE FEMALE AT LOWER END OF QUIET CHANNEL ABOVE GRAVEL RIFFLES. ALSO ONE MALE AND ONE FEMALE OBSERVED CRUISING SHORELINE OF THE LAKE ON THE WAY BACK.</p>
09/20/89 1000 LGB	AT3AT4 GOLD CR (LOWER)	<p>KOKANEE AGAIN FOULING UP BULL TROUT SURVEYS. SMALL PODS OF KOKANEE SPAWNING CLEAR UP TO GRAVEL PIT LAKE. KOKANEE LARGER THAN LAST YEAR AT 11-13 INCHES. STILL ONLY 4 BULL TROUT OBSERVED, TWO OF WHICH WERE IN SLACK WATER CHANNEL BELOW THE LAKE. NONE OBSERVED CRUISING THE LAKE THIS TRIP. MAY HAVE TO DROP THIS INDEX AREA BECAUSE OF KOKANEE INTERFERENCE WITH REDD COUNTS.</p>
09/27/90 1330 LGB	AT3AT4 GOLD CR (LOWER)	<p>From frontage road to Pond. Both redds along riprap run downstream from culvert. Walked about a mile above the pond without seeing any bull trout or redds. Temperature cooler above the pond (51F). Kokanee have appeared and are beginning to dig making furthur lower creek bull trout surveys impossible.</p>
09/13/91 1400 LGB	AT3AT4 GOLD CR (LOWER)	<p>Agreed to let USFS personnel from North Bend and Cle Elum Ranger Districts survey Gold Creek this season. They will be utilizing both bank and snorkel surveys, below Gold Cr Pond and above into the Wilderness Area to determine extent of upstream movement.</p>
09/20/91 NBRD FG	AT3AT4 GOLD CR (LOWER)	<p>DATA FROM JERRY SHERRID/FRED GOETZ NBRD USFS Performed habitat surveys from lake into wilderness area (some 6.8 miles total) between August 20 and September 20, 1991. Total adult bull trout count was 36-38 fish: 3 in Gold Cr Pond, 13-15 below pond outlet culvert (late) , and remainder mostly up into the wilderness. Took measurements on 14 redds out of 16 total redds located: 6 redds just below the pond culvert and most of the rest were up in the</p>

09/14/89 1201 EA

Y58Y59 INDIAN CR

AREA SURVEYED	FISH	REDDS
Mainstem fm S spring to N spring	12	7
Mainstem fm S spring to falls	6	10
North spring	11	3
South spring	5	4
Upper South spring	2	6

TOTALS	36	30

ALL REDDS MARKED WITH BLUE RIBBONS.
NO TEMPERATURE READING THIS TRIP.

09/28/89 1203 EA

Y58Y59 INDIAN CR

AREA SURVEYED	OLD	NEW	REDDS
FISH			
Mainstem N spring to S spring	7	3	10
0			
Mainstem fm S spring to falls	10	2	12
1			
North spring	3	2	5
0			
South spring	4	0	4
4			
Upper south spring	6	0	6
0			
Mainstem fm N spring to bridge		2	2
0			

TOTALS	30	9	39
5			

2/24/94

Bumping Lk. - Deep CK. Bull Trout Survey
Anderson 9/29/89

Below Rd. 1800

Fish Observed

Redds

0

5

(entrails of 1 large bull trout)

Above Rd. 1800 (approx. 1 mile above Rd - several braids)

Fish Observed

Redds

0

12

(carcass of 1 large bull trout)

Note: A survey of all main tributaries of Bumping Lk
should be conducted beginning early Sept. 1990.

Record#	MUCODE	DATE	INITIALS	WATEMP	ONREDD	OFFREDD	TOTLIVE	DEAD	CAUSE	REDDS	FALSE
631	Y52Y53	09/20/90	WDW	46F	0	0	11	0		16	0
632	Y52Y53	10/01/90	WDW	44F	0	0	0	0		32	0
1102	Y52Y53	08/20/93	EA	50F	0	1	1	0		0	0
1103	Y52Y53	08/31/93	EA	45F	0	0	0	0		0	0
1099	Y52Y53	08/19/93	EA	50F	0	9	9	0		0	0
1100	Y52Y53	08/31/93	EA	45F			12	0		5	0
1101	Y52Y53	09/08/93	EA	46F			5	2	POACHERS	38	4

Record#	MUCODE	DATE	INITIALS	WATEMP	ONREDD	OFFREDD	TOTLIVE	DEAD	CAUSE	REDDS	FALSE
30	Y58Y59	09/08/84	JS		6	140	146	1	CLUBBED	3	6
29	Y58Y59	09/15/84	JS	11C	20	25	45	0		29	22
1111	Y58Y59	09/12/85	JS				90	FALSE	IN CLUDED	69	INC
547	Y58Y59	09/17/85	JS				62	0		37	18
1112	Y58Y59	09/13/86	JS				45	PARTIAL	SURVEY	16	8
1113	Y58Y59	09/12/87	JS				20	FALSE	IN CLUDED	35	INC
584	Y58Y59	09/02/88	EA	43F			25	0		8	0
585	Y58Y59	09/09/88	EA	45F			25	0		22	0
586	Y58Y59	09/16/88	EA	48F	0	0	23	1	unknown	25	0
587	Y58Y59	09/26/88	EA	43F	0	0	0	0		25	0
588	Y58Y59	09/14/89	EA	?	0	0	36	0		30	0
589	Y58Y59	09/28/89	EA	47F	0	0	5	0		39	0
590	Y58Y59	09/25/90	EA	45F	0	0	27	0		69	21
591	Y58Y59	09/13/91	JLC	45F	0	0	61	FALSE	IN CLUDED	108	INC
592	Y58Y59	10/01/91	EA	46F	0	0	15	FALSE	IN CLUDED	123	INC
1045	Y58Y59	09/04/92	JLC	42F	LOTS	LOTS		NONE	NO COUNT	UNK	UNK
1041	Y58Y59	09/09/92	CWU				40	0		78	0
1043	Y58Y59	09/14/92	EA	46F			37	0		125	13
1042	Y58Y59	09/15/92	CWU				30	0		135	6
1044	Y58Y59	09/25/92	CWU				0	0		142	2
1104	Y58Y59	09/09/93	EA	47F	46	7	53	0		95	13
1105	Y58Y59	09/21/93	EA	46F			16	0		133	2
1106	Y58Y59	10/01/93	EA	46F	1	2	3	0		140	0

Deep Creek

Record#	MUCODE	DATE	INITIALS	WATEMP	ONREDD	OFFREDD	TOTLIVE	DEAD	CAUSE	REDDS	FALSE
581	Z16Z17	09/29/89	EA		0	0	0	2	ANGLERS?	17	0
582	Z16Z17	09/24/90	EA	47F	0	0	0	0		15	5
583	Z16Z17	09/10/91	EA	44F	0	8	8	1	UNKNOWN	84	3
1046	Z16Z17	09/01/92	EA	47F			21	4	POACHERS	77	8
1047	Z16Z17	09/10/92	EA	46F			3	0		78	7
1107	Z16Z17	08/13/93	EA	47F	0	0	0	0		0	0
1108	Z16Z17	08/24/93	EA	44F	9	0	9	0		15	2
1109	Z16Z17	09/02/93	EA	45F	13	0	13	3	2FM, 1STR	37	9
1110	Z16Z17	09/10/93	EA	46F	0	0	0	1	STRANDED	45	9

March 1, 1994

GOLD CREEK BULL TROUT SPAWNING SURVEYS

YEAR	LOWER CREEK (INCLUDING POND)		UPPER CREEK (ABOVE POND)	
	Total Redds Counted	Most Adult Bull Trout Observed	Total Redds Counted	Most Adult Bull Trout Observed
1984	2	(2)	no data	
1985	2	(2)	no data	
1986	21	(13)	no data	
1987	15	(7)	no data	
1988	12	(6)	no data	
1989	2	(4)	no data	
1990	2	(0)	9	(2)
1991	6	(16)	10	(20)
1992	3	(0)	11	(0)
1993	2	(2)	9	(17)

lgb

Larry Brown, Area Fish Biologist
Washington Department of Fish and Wildlife

Wednesday 9-13-89 11 AM ✓

PANTHER CREEK INDEX SURVEY

Beautiful fall day - cool AM - warm PM

White River low & milky blue - 50°F

Panther Creek low & clear - 50°F

<u>Redds</u>	<u>false</u>	<u>fish</u>	<u>Comments</u>
1	1	1 ♂ 21"	Rt. branch - redd at tailout of jet. pool. Little flow in left br.
0	0	0	to '88 peek-a-boo falls
0	0	0	trailhead - 14" piece 3/4" PVC w/coupling in Creek
<u>FOUND ANOTHER 50' section 3/4" PVC on left at trail</u>			
0	0	0	trail to Rock Wall pool
0	1	1 ♂ 28" 1 ♀ 24"	Packet eddy on left about 200' up from Rock Wall ♂ very beat/scarred
0	0	1 ♀ 24"	to falls below Poach site Very Spooky - Footprints
0	0	0	thru Poach site to Classic tailout. More Footprints
0	0	2 ♂ 1 ♀	Pool above Classic tailout, Very skittish. Beer cans, Cooler bottles.
0	0	1 ♂ 30"	left eddy base of log Falls ~7' high

<u>Redds</u>	<u>False</u>	<u>Fish</u>	<u>Comments</u>
1	0	0	about 50' above log falls - center
0	0	1? 24"	Bedrock crevice below next cataract - Very doubtful passage this year (as last year).
0	0	0	Cataract, flat and final cataract below main falls. Not likely to get here.
TOTAL REDDS		2	
TOTAL FALSE		2	
TOTAL FISH		9	(5♂, 3♀, 1unk)

Never have seen such skittish behavior in 6 years of surveys - suspect some foul play lately.

Suspect Pot ranch in vicinity of trail crossing (ie: PVC pipe). Reported to USFS enforcement coordinator at LK. WEN. R.D. Did Not search around area due to potential for booby-traps

Thursday 9-14-89



NOON

checked PVC pipe and trail vicinity
of Panther Creek with

Dep. Joe Herron K-27

Dep. Matt Fields K-31

USFS Darrel _____ (enf. coord.)

Nothing else found. Pipe
appears to be old & may have
washed down from ???
I doubt that myself.

Found fresh (slightly dried over)
blood spots along creek at
trail crossing. Looked like
fish blood (y; slimy) - one
camp - black pickup UT-1254
(Puyallup - Fort Lewis) at Grasshopper.
wet tennis shoes & pair jeans
hanging up - No one in rig
or tent. Roped raft crossing
just above Panther mouth. Yellow
and blue vinyl raft on
panther creek side up on
bank. We missed whoever
was up there.

Friday 9-15-89

Gold Creek 0900 52°F

I-90 to Lake



Redds	False	Fish	Comments
1	0	0	between I-90 & frontage New channel split Right channel (dry '88)
0	0	0	to Culvert - Jack cleaned rocks at lower end culvert.
0	0	0	riffled channel
0	0	1 ♂ 30" 1 ♀ 24"	lower end quiet
0	0	1 ♂ 28" 1 ♀ 30"	upper channel cruising lake near outlet

1 Redds
0 false
4 fish

Friday 9/15/89 NOON ✓
Box CANYON CREEK 50°F
creek flows to lake, but reduced
flow on alluvium.

~~fish~~
Redds False Fish

0 0 0 to pool below
Peek-a-bow falls

0 0 5 * Peek-a-bow pool.

observed approx. 5 from 18" to 30"
6-10 leaps and 10-12 "peeks".
2 fish were lying on tailout
as approached - spooked into pool.
Best jump was only 2/3 of the way
up to first step.
USFS spotted car for us.

USFS crew surveyed 2 days ago
call for data. Scott Edson
Cle Elum R.D.

-doing habitat survey - obs. 2 bulls
(1 in bedrock pool w/ trout) (1 below Peek-a-bow)
No Bulls above Peek-a-bow Falls
NOTE: 20' vertical Falls 1/8 mile above
USFS Road Bridge (culvert)

Wednesday Sept. 20, 1989 ✓
 GOLD CREEK 52°F 1000 HRS.

Redds	False	Fish	Comments
1	0	0	between I-90 & Frontage Rd Bridge
(4)	(2)	0	under Frontage Bridge
(2)	0	25K	pool 50' upstream 25 large Kokanee at 11-13"
(2)	(2)	20K	<u>Kok Redds</u> left chan. to Bvr. Dam
0	0	0	center chan. to split
0	0	0	19 most unspawned 31 cm
0	0	0	main (Rt) chan. to split
0	0	19 DV 22"	tail of long pool above split
0	0	19nk DV 24"	log scale pool
(9)	0	15K	Kok reds 100yd above log scale pool
0	0	0	Bedrock Pool
0	0	10 ⁷ 28"	top of culvert under log
1 (nest)	0	0	25' above culvert
0	0	10 ⁷ 26"	tail of slack channel
0	0	0	to lake
0	0	0	Lake shore

total Bull Redds (2)
 total Bull Trout (4)
 Kok Redds (17) with approx. 75-100 Koks 11-13"

L. DAVLING CORP.
 TACOMA, WASH. USA
 "Rate in the Rain"
 WEATHERPROOF
 NO. 352

Wednesday Sept. 20
Box Canyon Creek

48.5°F 1300 ✓

NO Fish

NO Redds

NO False

No Jump/cruise/peck at Falls

1/3 to 1/2 discharge getting to
Little Kachess Lake (r 30fs)

appear to have lost the 4 or 5
fish observed at peek-a-bow
last week. no sign of them.

Thursday 9-21-89 1330 HRS ✓

White clearing some 50 °F

Panther low & clear 48.5 °F

Redds ^(Red) false fish Comments

0	0	0		To Jet
1 center	0	0		Jet Pool Tailout
1 Rt.	0	0		Rt. Tailout 20' below log & 100' below Rock falls
0	0	0		thru rainbow pool
0	0	0		trailhead
0	1 Left	0		slack Rt. Face Rock Wall pool
active 1 Left ctr	0	1 ♂ 24"		upstream end log-Rock wall tail
2 Left	0	1 ♂ 27"		packet eddys above/below lg. boulder 200' above Rock Wall
1 left	1 Rt.	0		100-150' down from Falls below poach site
active 1 Rt.	0	2 ♂ 26" 24"		Rt. tail long Pool below Poach
1 Left	0	0		Males active aggression
1 Left	1 Rt	0		unatt end. tail under log
				Redd under boulder eddy
				Same place as in '88
2 ctr	0	0		Riffle under Poach Pool
1 Left	0	0		tail of poach Pool
1 Rt. ctr	1 Rt	0		slack tail poach pool
2 ctr	0	1 ♂ 28"		10' up from poach pool
		1 ♀ 26"		25' up from Poach Pool
5	0	0		Rt. ctr riffle below
				classic tailout
3	1 Left	1 ♂ 28"		classic tailout
		1 ♀ 24"		

J. DARLING CORP
TACOMA, WASH.

Redd in the Rain
WEATHER PROOF

NO. 352

Redds	false	fish	Comment
0	0	1 ♀ 24	lying near head classic pool
0	0	2 ♂	lying at head classic pool
1 left	0	0	pocket below log falls
1 ctr	0	1 ♀ 24"	tail of log fall pool
1 otr	0	0	enlarged from last wk 50' above log falls
1 left	0	0	Bedrock eddy just below stop. Did see 6-8 trout(?) zipping around on pool all about 7-10" long

2 old redds } 27 total Redds
 25 New Redds }
 5 false Redds }
 15 fish obs. 7 ♂ 8 ♀

10/3/89

PANTHER CR

45°F low/clear ✓

1230 PM

WHITE R

44°F Low/clear

PANTHER SURVEY

	Redds	Fish
Mouth to Peek Falls	② below JCT. ② + 2 JCT TO Peek Falls	♂ ♂
Peek Falls to Trail	∅	∅
Trail To Poach Pool	9 + 1F	∅
Poach Pool to Log Falls	15 + 2F	2 ♂ classic tail to
Log Falls to impass	1 (5' above log)	∅

+ 1 side pool at impass

total Redds 3B + 3 False

total Fish 4 ♂ 2 ♂ 24 & 28"
+ 1 ♂ + 1 ♀

I.D. did small fish obs. above barrier at RB (caught 3)

At top eddy/pool redd enticed 18" 1 ♀ out from
boulder hideholes w/ mepps ♀ 19" TL ♂ 25" TL
+ 1 RB to mepps (all RBs 7-9")+ 1 Redd Rt bank below Log Falls (oops)
White River at ford.2 redds at chinook bed Rt bank
above grasshopper clst. and 2 redds
on left bank at ford (smallish)
done 4 PMLooks about over - only one
attended redd.